

# Keysight Passive Probe Overview

## N28xxA/B General-purpose

- High resistance (10 MΩ) for low loading
- Up to 500 MHz
- Frequency tuned version of N2862B/63B/89A/90A

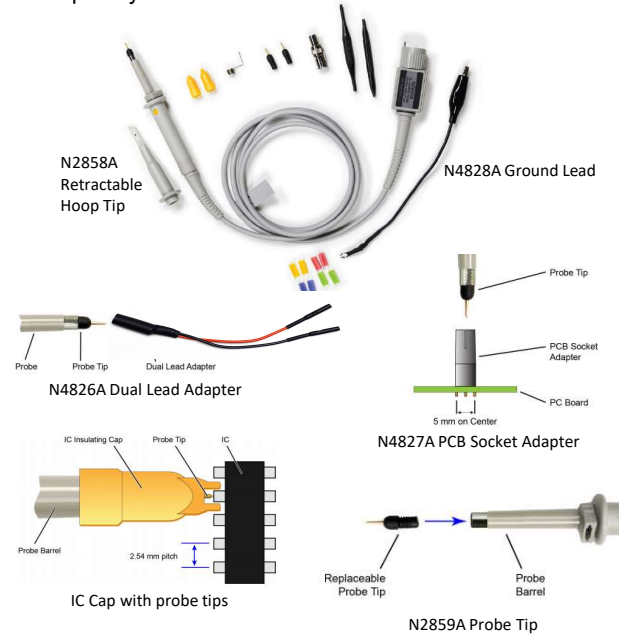

Model	Input Impedance	Bandwidth	Attenuation Ratio	Ref Price
N2840A	10 MΩ / 15 pF	50 MHz	10:1	
N2841A	10 MΩ / 15 pF	150 MHz	10:1	
N2842A	10 MΩ / 11 pF	300 MHz	10:1	
N2853A	10 MΩ / 11 pF	350 MHz	10:1	
N2843A	10 MΩ / 11 pF	500 MHz	10:1	
N2889A	10MΩ / 11pF 1MΩ / 60pF	350 MHz 10 MHz	10:1 1:1 switchable	

[Data Sheet](#) [User Guide with all accessories](#)

N2856A Passive probe accessory Kit

N2857A Alligator ground lead Qty:1

N2858A Retractable hoop tip adapter Qty:1

N2859A Replaceable probe tip Qty:1

N4826A Dual lead adapter Qty:2

N4827A PCB socket adapter Qty:2

N4828A Ground Springs, 5 mm Qty:2

## N2140A Passive Probe

- Bandwidth DC to 200 MHz
- Cable length 1.3 m
- Switchable 1:1 or 10:1 attenuation ratio



Model	Input Impedance	Bandwidth	Attenuation Ratio	Ref Price
N2140A	10MΩ / 15pF 1MΩ / 100pF	200 MHz 6 MHz	10:1 1:1 switchable	
N2142A	10MΩ / 15pF 1MΩ / 100pF	75 MHz 6 MHz	10:1 1:1 switchable	
N2143A	Accessory Kit			

## High Performance up to 1.5 GHz

- Small 2.5 mm probe tip
- Replaceable spring-loaded probe tip for reliable contact
- 1:1, 10:1, 20:1 and 100:1 attenuation ratios with auto probe ID readout
- Wide compensation range for a variety of scope inputs
- Comes with various probe tip accessories
- Optional probe accessory kits

INCLUDE STANDARD (Trimmer tool is not in N2874/76A)



Model	Input Impedance	Bandwidth	Attenuation Ratio	Ref Price
N2870A	1 MΩ / 39 pF	35 MHz	1:1	
N2871A	10 MΩ / 9.5 pF	200 MHz	10:1	
N2872A	10 MΩ / 9.5 pF	350 MHz	10:1	
N2873A	10 MΩ / 9.5 pF	500 MHz	10:1	
N2875A	20MΩ / 5.6pF	500 MHz	20:1	
N2894A	10MΩ / 9.5pF	700 MHz	10:1	
N2874A	500Ω / 1.8 pF	1.5 GHz	10:1 (50Ω)	
N2876A	5KΩ / 2.2pF	1.5 GHz	100:1 (50Ω)	

[Data Sheet](#) [User Guide with all accessories](#)

N2877A Deluxe Kit for passive probes (check user guide for detail)

N2879A Fine Pitch Kit (check user guide for detail)

N2878A General Purpose Kit (check user guide for detail)

N2885A PCB Socket Adapter Kit (check user guide for detail)

N4829A Probe tip kit (Rigid and spring loaded) Qty:10

N4831A Sprung hook tip Qty:2

N4836A Dual lead adapter Qty: 2

## Other Passive Probes

### 10076C 3.7KV 100:1 High Voltage Passive Probe

10076C Standard Kit

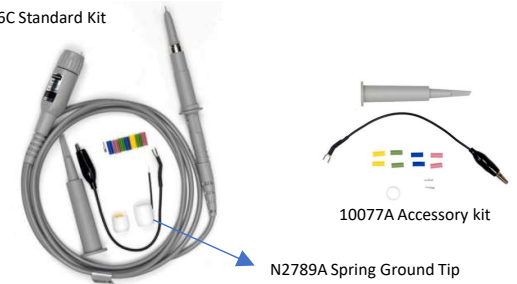

Model	Input Impedance	Bandwidth	Attenuation Ratio	Ref Price
10076C	66 MΩ / 3 pF	500 MHz	100:1 (up to 3.7KV)	
10077A	Accessory kit			
N2789A	Spring GND tip			

### 10070 Passive Probe

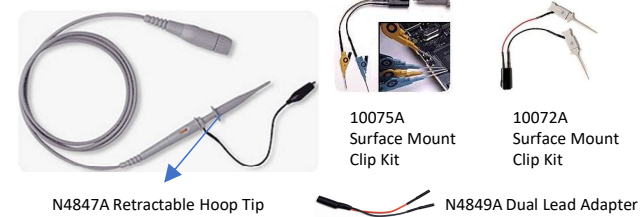

Model	Input Impedance	Bandwidth	Attenuation Ratio	Ref Price
10070D	1 MΩ / 70 pF	2- MHz	1:1	
10073D	2.2 MΩ / 12 pF	500 MHz	10:1	
10074D	10 MΩ / 15 pF	150 MHz	10:1	
10072A	Surface Mount Clip Kit			
10075A	0.5 mm IC Clip Kit			

### N7007A Extreme Temperature Passive Probe

- Wide operating temperature range of -40 to +85 °C for extreme temperature environmental chamber testing
- 400 MHz bandwidth (-3 dB)
- High impedance (10 MΩ at DC) input
- Wide input range: 1 kV CAT II, 600 V CAT III

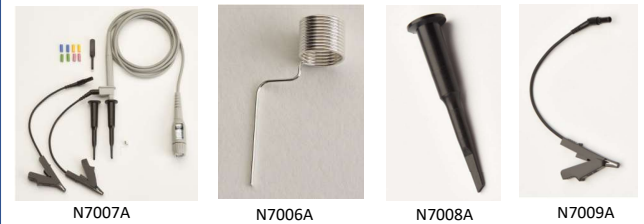

Model	Input Impedance	Bandwidth	Attenuation Ratio	Ref Price
N7007A	10 MΩ / 15.5 pF	400 MHz	10:1	
N7006A	Spring Ground Tip			
N7008A	Retractable Hook Tip			
N7009A	Alligator Ground Lead			